

## INSTALLATION: CEILINGS

Rams Insulation is safe and has no health risks associated with the installation process. No protective clothing is required when installing. Wool Insulation is very flexible and strong. Rams Insulation has long lasting durability. Do not compress bulk insulation as this will reduce its effectiveness. Ensure there is sufficient space for the insulation to retain its normal thickness.

**Note:** Use a broom handle or pole to install in tight areas that are traditional hard to get too.

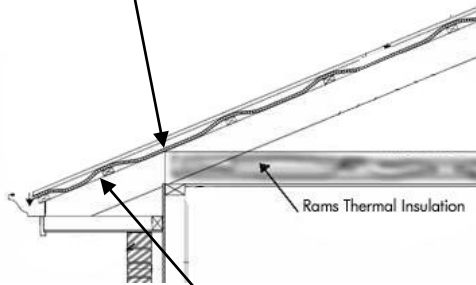

**Note:** Place **SARKING** directly under the roofing material between the battens and the rafters with the shiny side facing down.

- Ensure that a certified electrical contractor has checked the wiring in the ceiling first.
- Place bulk insulation between the joists.
- Leave no gaps especially in areas were difficult to reach.
- Don't compress the bulk insulation, it will reduce the effectiveness.
- Carefully take precaution when walking in a ceiling space.
- Where applicable use **Downlight** covers before installation.

## INSTALLATION: FLOORS



- Ensure that a certified electrical contractor has checked the wiring in the floor first.
- Place the bulk insulation between the joists neatly and snug.
- Leave no gaps especially in areas were difficult to reach.
- Don't compress the bulk insulation, it will reduce the effectiveness.
- Use fishing string, nylon cord or blue strapping tape to support the installation

### WARNING:

Installing Rams Insulation will be a cost effective way to save hundreds of dollars per year on heating and cooling. However it's important to note the following points:

- Always check first with a certified electrical contractor that all wiring is in good order.
- Never compromise the bulk insulation with a lower R-Value than stated.
- Fill in all air gaps.
- Ensure that **Downlight** covers have been placed before installation
- All Insulation should be installed in accordance with AS/NZ 3999